



CROFTS ESTATE AGENTS

PASSIONATE ABOUT PROPERTY

CLEETHORPES
01472 200666

IMMINGHAM
01469 564294

LOUTH
01507 601550

SALES LETTINGS NEW HOME SALES LAND PROPERTY MANAGEMENT AUCTIONS FINANCIAL ADVICE AND MORTGAGES ENERGY PERFORMANCE PROVIDER



Trefoil Close

Grimsby
DN33 3BB

Monthly Rental Of £750
Deposit Of £850

Crofts Estate Agents are delighted to bring to the market this superbly presented and stylish two large double bedroom mews house, located off Springfield Road in Scartho. This delightful property creates an ideal location, with early viewing highly advised on what in this agents opinion will be a most popular property. Internally the property briefly comprises of a lovely sized living area, modern fitted kitchen diner, WC, landing, modern bathroom and then finally the two large double bedrooms wider than the usual build due to the extra space over the alleyway. The front garden is of an open plan style with lawn and block paved driveway. The rear garden is south facing and therefore gets plenty of sunshine throughout the day.

CLEETHORPES: 62 St Peters Avenue, Cleethorpes, DN35 8HP

IMMINGHAM: 21 Kennedy Way, Immingham, DN40 2AB

LOUTH: 3 Market Place, Louth, LN11 9NR

Email: Cleethorpes:

Email: Immingham :

Email: Louth :

info@croftsestateagents.co.uk

immingham@croftsestateagents.co.uk

louth@croftsestateagents.co.uk

www.croftsestateagents.co.uk



Lounge

15' 10" x 12' 8" (4.82m x 3.86m)

Entering the property will lead you to the lounge, this is a good sized space decorated with grey carpet and white walls throughout. Next to the front door you will find a UVPC double glazed window with a central heated radiator just beneath.

Kitchen

12' 8" x 12' 1" (3.86m x 3.68m)

The kitchen is clean and modern looking with its large marble effect tiled floors and white painted walls throughout. The kitchen has matching white base and wall units with a black worktop to finish it off. This kitchen offers an integrated oven/hob along with a silver splashback. The kitchen is L shaped leaving extra space for dining furniture.

Downstairs WC

6' 0" x 3' 3" (1.83m x 0.99m)

The marble effect tiled floors are followed though to the downstairs WC along with the white walls, you will find white wash basin along with a WC, on the wash basin you will find a modern patterned splashback and a small central heated radiator just next to the basin.

Bedroom 1

16' 6" x 12' 1" (5.03m x 3.68m)

This bedroom is an impressive space which has been decorated with grey carpet and white walls throughout, there are mirrored fitted wardrobes in the corner of the bedroom along with additional cupboard space in two different corners of the room.

Bedroom 2

16' 6" x 8' 9" (5.03m x 2.66m)

Bedroom 2 is also a spacious room decorated with grey carpet and white painted walls, with additional cupboard space in the right far corner. You will find as you walk into the property a UVPC double glazed window with a central heated radiator just below.

Bathroom

7' 1" x 6' 0" (2.16m x 1.83m)

This bathroom is freshly decorated with grey vinyl floor with light grey painted walls which have been half tiled with a darker shade of grey. The basin is white with a black storage cabinet below it and then a matching two piece suite of a white bath/shower and WC.

Landing

The landing will allow you access to each room on the first floor of the property, it is decorated with grey carpets throughout and white painted walls.

Tenure

Believed to be Freehold, awaiting solicitors' formal confirmation.
All interested parties are advised to make their own enquiries.

Services

All mains services are understood to be connected, however Crofts have not inspected or tested any of the services or service installations & purchasers should rely on their own survey.

Viewings

Please contact the relevant marketing office, all viewings are strictly by appointment only please.

Council Tax Information

Band B: To confirm council tax banding for this property please view the website www.voa.gov.uk/cti

Free Valuations

We offer a free valuation with no obligation, just call the relevant office or visit www.croftsestateagents.co.uk seven days a week to arrange for your free valuation.

Property Management

We offer a full property management service, offering full and comprehensive credit and referencing checks detailed photographic inventories and regular property inspections to name just a few of our services.

Mortgage and Financial Advice

With access to the whole of the mortgage markets, Crofts Estate Agents in connection with The Mortgage Advice Bureau will help you find the best mortgage to suit your needs. The Mortgage Advice Bureau will act on your behalf in advising you on mortgages and other financial matters

STATUTORY NOTICE: YOUR HOMES IS AT RISK IF YOU DO NOT KEEP UP REPAYMENTS ON A MORTGAGE OR OTHER LOAN SECURED ON IT.



GROUND FLOOR
32.8 sq.m. (353 sq.ft.) approx.

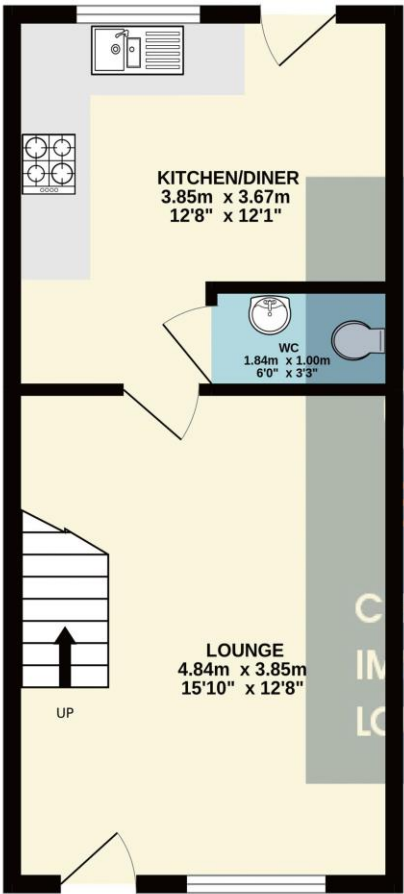

1ST FLOOR
42.8 sq.m. (460 sq.ft.) approx.

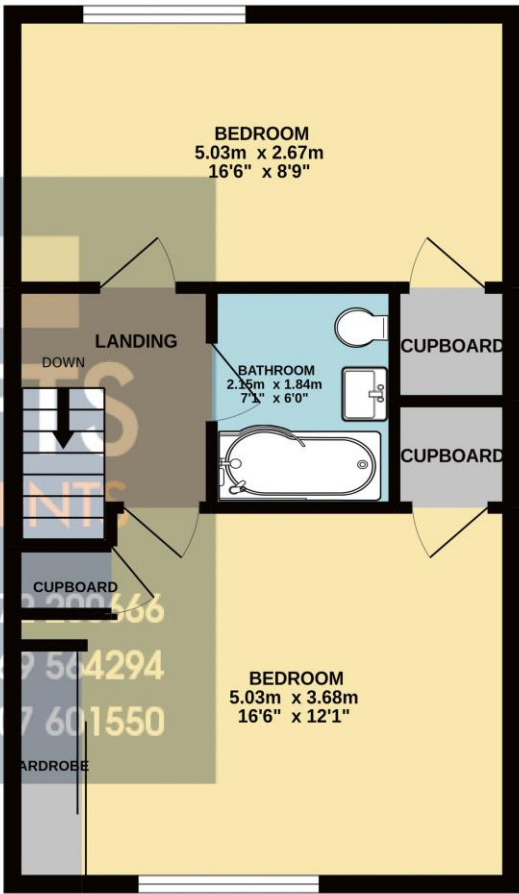

TOTAL FLOOR AREA : 75.5 sq.m. (813 sq.ft.) approx.

Whilst every attempt has been made to ensure the accuracy of the floorplan contained here, measurements of doors, windows, rooms and any other items are approximate and no responsibility is taken for any error, omission or mis-statement. This plan is for illustrative purposes only and should be used as such by any prospective purchaser. The services, systems and appliances shown have not been tested and no guarantee as to their operability or efficiency can be given.

Made with Metropix ©2022

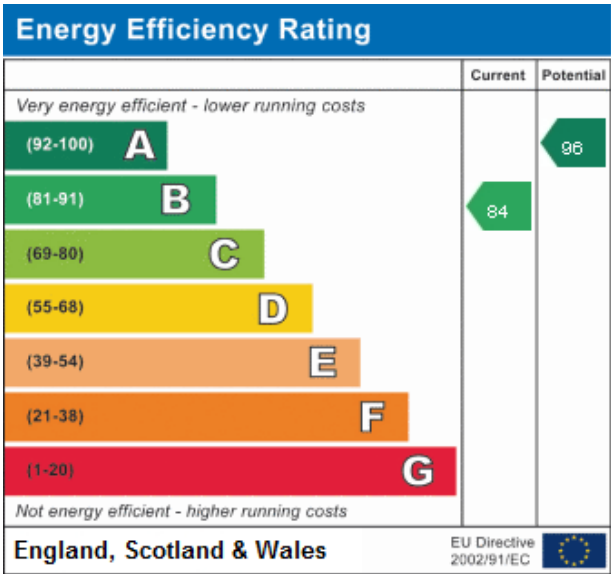

DISCLAIMER - IMPORTANT NOTICE REGARDING SALES PARTICULARS Although we have taken great care to insure the accuracy of the information contained in these particulars, we specifically deny liability for any mistakes, omissions or errors and strongly advise that all proposed purchasers should satisfy themselves by inspection or otherwise, as to their correctness, prior to entering into any commitment to purchase. In particular any information provided in respect of tenure, council tax, rateable values etc has been given in good faith and whilst believed to be correct, may be subject to amendment. Any references to the condition, use or appearance of the property are made for guidance only, and no warranties are given or implied by this information. It is not Crofts policy to check the position with regards to any planning permission or building regulation matters and as such all interested parties are advised to make their own enquires, in order to ensure that any necessary consents have been obtained. All measurements are approximate and are for guidance only and cannot be relied upon. Measurements are taken from wall to wall unless otherwise stated, with the metric conversion shown in brackets. Any plans or maps contained are for identification purpose only, and are not for any other use but guidance & illustration. Crofts have not tested any apparatus, equipment, fixtures, fittings or services including central heating systems and cannot therefore verify that they are in working order, or fit for their intended purpose. These details do not form any part of any contract, and unless specifically stated otherwise, furnishings and contents are not included within this sale.